

Confirm if the motorcycle has the original charge cable with the battery.

If Yes

If No

Open the board below the seat

Remove the seat



Fix the terminals with the battery

Connect the terminal with Battery Spirit

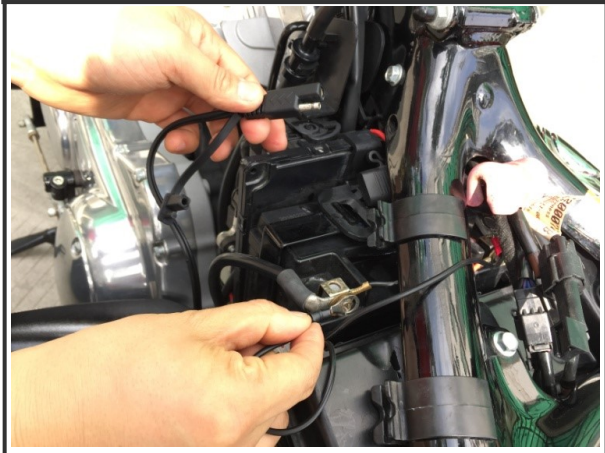
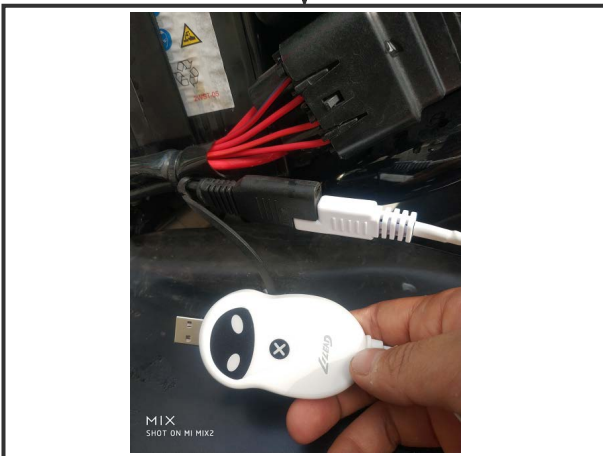
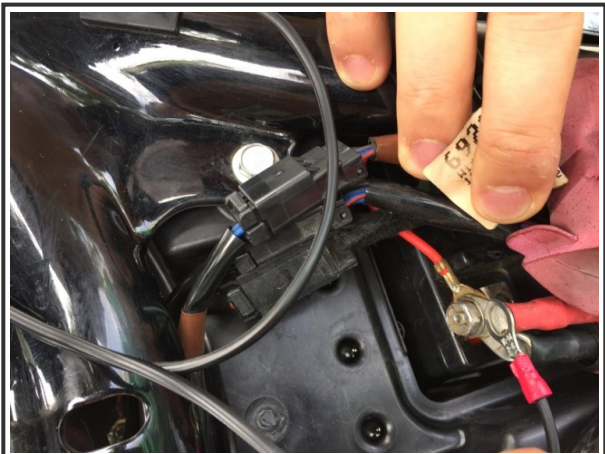

Start to charge

Fix the other terminal somewhere of the motorcycle



Connect with power bank to charge

Connect with phone adapter to charge

Start to charge

